

<b>Project and Designer Information:</b>	
<b>Region:</b>	Central North Carolina
<b>School Information:</b>	Middle School
Property (DSP) No:	4806
Design Capacity:	1,200 Students
Core Capacity:	1,350 Students
Grade Organization:	6-8
<b>Architect:</b>	Hord Coplan Macht 1942 East 7th Street, Suite 260, Charlotte, NC 27204 PH: 704.516.9972 Email: glang@HCM2.com Website: www.hcm2.com
<b>Other Recent Prototype Locations:</b>	
Times Prototype has been Constructed:	4
<b>Construction Costs &amp; Building Area:</b> (Does not include land, legal, design fees, testing, or furnishings)	
Date Bids Received	2/5/2016
Construction Bid Cost	\$24,549,166
Architectural Building Area	138,414 SF
Assignable Area	92,065 SF
Assignable To Total Architectural Area Efficiency	66%
Cost per Assignable Square Foot	\$266.65
Cost per Total Architectural Square Foot	\$177.36
Cost per Student	\$20,458
Special Costs included in Bid	none (school shares a bus lot with an existing adjacent school for this prototype site)
Description of Special Costs:	Community Center in lieu of a traditional multi-purpose room
Total Building Footprint (total all floors) Area	131,196 SF
Site Acreage	43.63
<b>Construction Information:</b>	
Building Code Construction Type	II-B, Fully Sprinklered
Construction Description	Load bearing CMU w/ steel frame at two-story areas
Roof	Single Ply - PVC
Number of Floors	2
Number of Separate Buildings	2
Heating Fuel	Gas
Heating & Air Conditioning	Air cooled chiller; Hot water boiler; HW terminal reheat; VAV AHU via variable primary / secondary pumping with VFDs; DDC controls
<b>Design Consultants:</b>	
Civil	Alfred Benesch and Co., Charlotte, NC 28208
Structural	JDH Structural Engineers, PLLC, Cornelius, NC 28031
Plumbing/Mechanical / Electrical	CMTA, Inc., Charlotte, NC 28205
Other – Food Service	Herbin Design, Charlotte, NC 28212
<b>Designer and Owner Comments:</b>	
<p><b>Designer Comments:</b> One of the goals of the design was to increase efficiency and reduce total construction dollars without compromising educational program. The two-story design features a compact plan that reduces exterior wall area, reduces circulation space and can be easily adapted to varying site conditions. This prototype was uniquely designed to minimize the footprint and be adaptable to almost any site. With large parcels of land harder to acquire, the efficiency of a two-story design approach is paramount. The strategy also allows for the prototype design to be modified to a single story or three-story classroom wing based on actual site constraints and owner needs.</p> <p><b>Owner Comments:</b> Each of the program spaces in this prototype have been analyzed and evaluated for its feasibility and functionality. Where possible, historically underused spaces have been reduced or combined with other spaces to enhance function and eliminate wasted space. Core teaching spaces include 36 general classrooms, 9 science classrooms, 4 Tech Ed classrooms, 5 Arts classrooms, and 2 resource classrooms. The cafeteria serves 450 students in three servings. The gymnasium bleachers seat 450 students while also providing a full view to the stage area. The stage is also designed to serve as a small auxiliary gym and can be modified to open to the cafeteria, if desired. Corridor widths increase based rooms served / student load requirements for safe student movement.</p>	

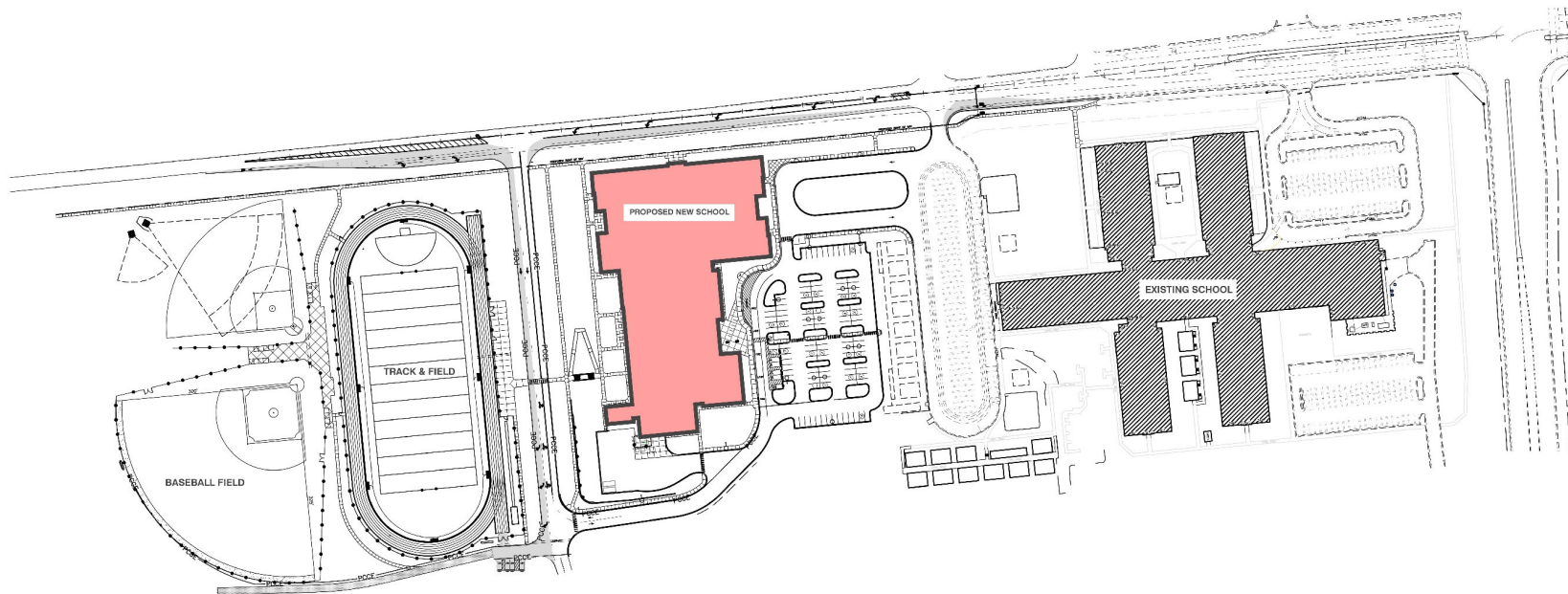

## PROTOTYPE MIDDLE SCHOOL

SITE : 41.48 ACRES  
BUILDING : 131,268 SQFT

00 0 40 80 160  
SCALE: 1"=80'



Second Floor

- CLASSROOM
- ARTS CLASSROOM
- CTE CLASSROOM
- MEDIA CENTER
- PHYSICAL EDUCATION / ATHLETICS
- ADMINISTRATION
- WORKROOM / TEAM AREA
- CAFETERIA / KITCHEN
- SERVICE / TOILETS / STORAGE
- ACCESSIBLE RAMP / ELEVATOR

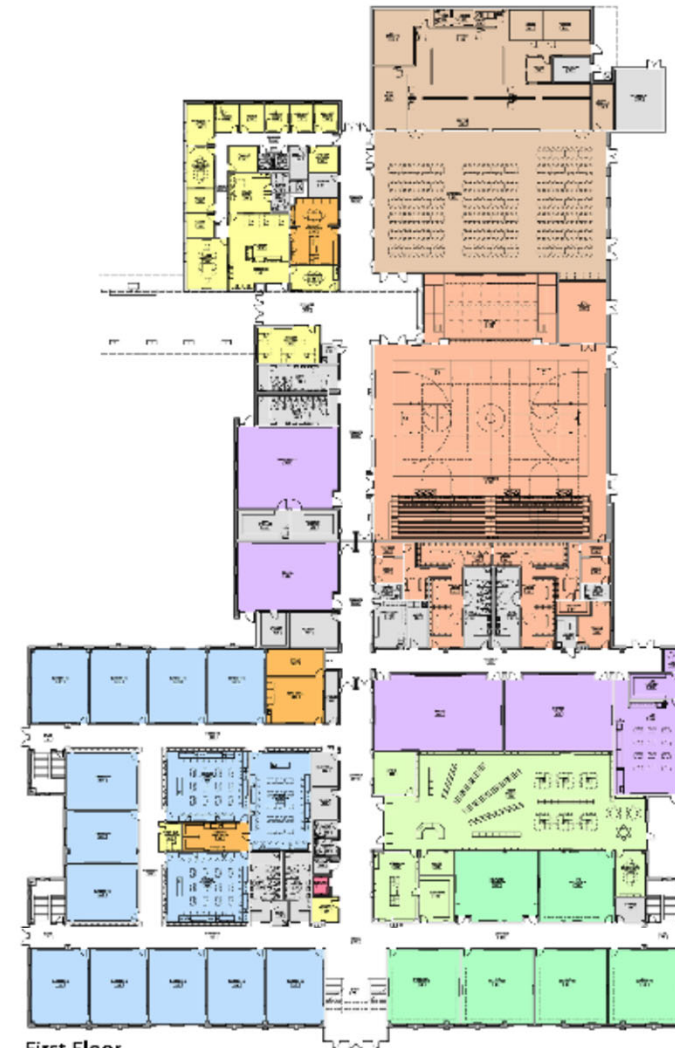

First Floor



**hord | coplan | macht**

The original Architect of Record as identified herein shall retain ownership of this Prototype Design. Any use other than incidental printing of this design for further study, is prohibited.

# Middle School Prototype











